

Clamp Gaskets

Feature:

- Gasket material approved by  (3A), USDA and complies with FDA's 21CFR177.2600 and 1550. PSI Service Ratings for the sanitary clamps DO NOT APPLY to connections (1" and above) using any PTFE gaskets, due to the potential for cold flow under normal operating conditions. PTFE gaskets, when used with any clamp, are likely to leak at pressures far below the published service ratings. This restriction does not apply to the fractionally sized 1/2" and 3/4" connections, due to their recessed, fully contained design.

Sanitary Fittings

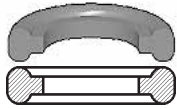

Mini



Standard - type 1

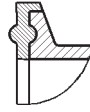

Flanged - type 2

Buna-N - Black

Features:

- color code: red dot
- meets 21CFR 177.2600

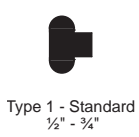

Type 1 - Standard
1/2" - 3/4"



Type 1 - Standard
1" and larger

Size	Buna-N Part #
1/2"	42MP-U50
3/4"	42MP-U75
1"	40MP-U100
1 1/2"	40MP-U150
2"	40MP-U200
2 1/2"	40MP-U250
3"	40MP-U300
4"	40MP-U400
5"	40MP-U500
6"	40MP-U600
8"	40MP-U800

Buna-N - White

Features:

- color code: red dot
- meets 21CFR 177.2600

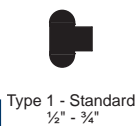

Type 1 - Standard
1/2" - 3/4"



Type 1 - Standard
1" and larger

Size	Buna-N Part #
1/2"	42MP-UW50
3/4"	42MP-UW75
1"	40MP-UW100
1 1/2"	40MP-UW150
2"	40MP-UW200
2 1/2"	40MP-UW250
3"	40MP-UW300
4"	40MP-UW400
6"	40MP-UW600

EPDM - Black

Features:

- color code: three green dots
- peroxide cured
- meets 21CFR 177.2600
- passed USP Class VI Cytotoxicity testing

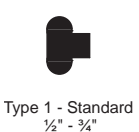

Type 1 - Standard
1/2" - 3/4"



Type 1 - Standard
1" and larger

Size	EPDM Part #
1/2"	42MP-E50
3/4"	42MP-E75
1"	40MP-E100
1 1/2"	40MP-E150
2"	40MP-E200
2 1/2"	40MP-E250
3"	40MP-E300
4"	40MP-E400
6"	40MP-E600

Visit dixonvalve.com for sizing charts